



# HOSHIZAKI

## KM-130C DAILY ICE PRODUCTION CAPACITY UP TO 130KG

CRESCENT ICE MAKER SERIES

This KM series ice maker produces clear, crescent-shaped ice that is extremely versatile. It features a double-sided stainless steel evaporator that requires fewer cycles to produce a full container of ice, reducing energy consumption and extending life. The all-new C-Series offers improved hygiene features, IoT connectivity and more to meet higher customer expectations.

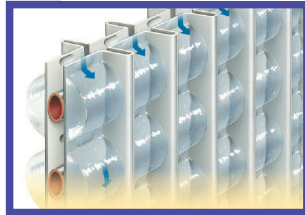

## FEATURES

### 1. NEW DOOR DESIGN

- Stainless steel door for improved aesthetics and durability
- Front opening ergonomic design
- Gasket to prevent insects from entering
- New scoop holder for more hygienic operation (Easily detachable design)

### 2. NEW OPERATION PANEL

- Easy to recognize and diagnose machine conditions with new display



### 3. NEW UV-LED (OPTION)

- Sterilize water in the machine for hygienic ice



### 4. NEW CLEANING FUNCTIONS

- Automatic chemical cleaning for greater hygiene and longer life of the machine

### 5. NEW IoT CONNECTIVITY



### 6. ENERGY SAVING

- Individual premium crescent cube with no ice bridging
- Exceptionally hard crystal clear cubes that melt slowly
- Retractable front air filter for easy cleaning while maintaining performance
- Double-sided stainless steel evaporator for all water conditions produces more ice in less cycles
- Snap in water tank design - easy to remove for sanitization
- Durable stainless steel exterior
- Low water electrical consumption
- Flush mount to rear wall
- Good in hard water areas

## ICE SIZE

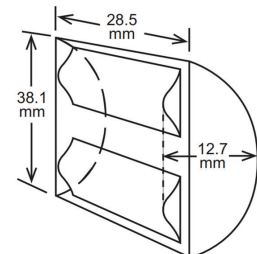

## CERTIFICATION



# DIMENSIONS & SPECIFICATION

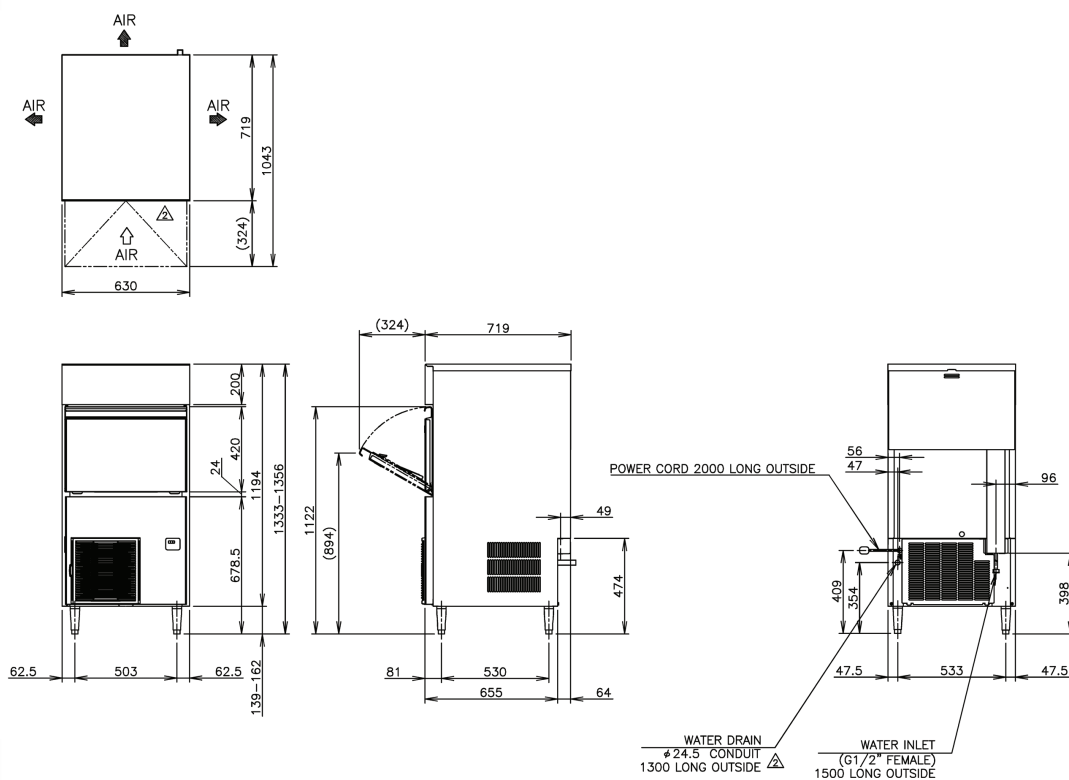

NO SCALE

<b>KM-130C</b>	
<b>ICE DIMENSIONS (WxDxH)</b>	28.5 X 12.7 X 38.1 mm
<b>DIMENSIONS (WxDxH)</b>	630 X 719 X 1333 (-1356)mm
<b>PACKAGE DIMENSIONS (WxDxH)</b>	725 X 825 X 1357 mm
<b>WEIGHT (NET/GROSS)</b>	69 KG / 81 KG
<b>AMPERAGE / STARTING AMPERAGE</b>	4.3A / 18.4A
<b>ELECTRICAL CONSUMPTION</b>	593W(Power factor : 60%)
<b>REFRIGERANT CHARGE</b>	R404A / 220g
<b>HEAT REJECTION (AT32°C/WT21°C)</b>	1380W
<b>ICE PRODUCTION PER 24H</b>	(AT10°C/WT10°C) 130 KG
	(AT21°C/WT15°C) 120 KG
	(AT32°C/WT21°C) 90 KG
<b>ICE PRODUCTION PER CYCLE (AT21°C/WT15°C)</b>	Approx. 1.86KG / 208 pcs FREEZE CYCLE TIME PER CYCLE 22 minutes
<b>WATER CONSUMPTION PER 100KG ICE (AT32°C/WT21°C)</b>	0.15 m <sup>3</sup>

**NOTE: OPERATING CONDITIONS:**

All dimensions indicated are Width x Depth x Height in mm  
\*60Hz units are available on request

- Voltage Range: 220 - 240 V ±6%
- Ambient Temperature: 1°-40°C
- Water Supply: 5-35°C/0.07-0.8Mpa
- AC Supply Voltage: 1/220-240V / 50Hz