



HOSHIZAKI

> DCM-60KE

Daily ice production capacity up to 60KG

> DCM-120KE

Daily ice production capacity up to 125KG



Cold drinks are very much favoured especially in casual or self-service environments; operators can lessen the work or manpower with an ice dispensing machine. Hoshizaki's cubelet ice dispensers meet the need with its 2-in-1 function that makes and provides ice to customers through its compact and space saving dispensers.



ICE DISPENSER SERIES

FEATURES

- > push lever dispensing system
- > adjustable portion control to reduce energy consumption and wastage
- > auger system brings water consumption equal to ice production
- > easy to clean and maintain
- > direct dispensing reduces risk of contamination
- > compact with reduced space requirements
- > clean and hygienic

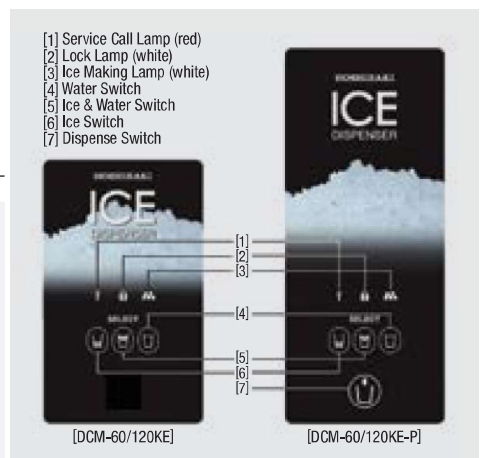
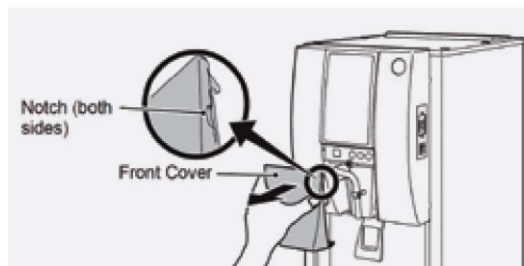

CUBELET ICE DISPENSER AIR SYSTEM

TOP SIDE

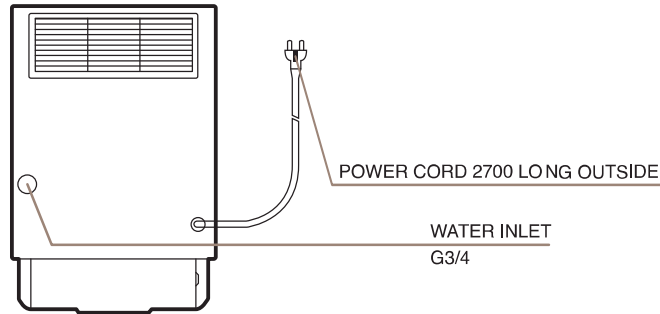

FRONT SIDE

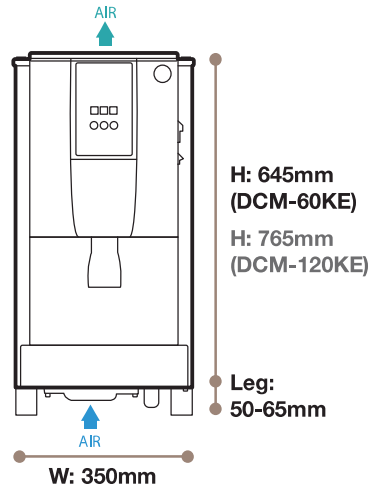

RIGHT SIDE

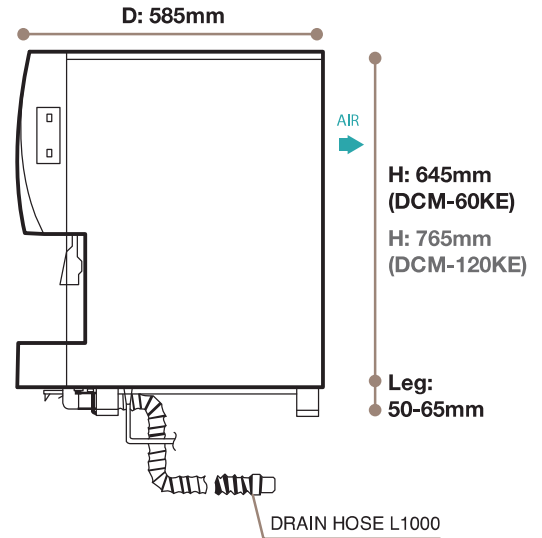

| MODEL NAME | DCM-60KE | DCM-120KE | |
|---|--|--|---------------------------|
| ICE SHAPE | Cubelet (Compressed Flake Ice) | | |
| DIMENSIONS (MM) (W x D x H) | Body : 350 x 585 x 645 / Leg Height : 50-65 mm | Body : 350 x 585 x 765 / Leg Height : 50-65 mm | |
| PACKED DIMENSIONS (MM) (W x D x H) | 440 x 655 x 931 | 440 x 655 x 1051 | |
| WEIGHT (NETT/GROSS) | 47KG / 56 KG | 57 KG / 66 KG | |
| AMPERAGE / STARTING AMPERAGE | 1.5A / 9.5A | 2.8A / 12.6A | |
| ELECTRICAL CONSUMPTION | 280 W | 480 W | |
| REFRIGERANT CHARGE | R134a | | |
| HEAT REJECTION | 460 W (396 kcal/h) | 980 W (843 kcal/h) | |
| ICE PRODUCTION PER 24H (15MM) | (AT10°C/WT10°C) | 60 KG | 125 KG |
| | (AT21°C/WT15°C) | 50 KG | 105 KG |
| | (AT32°C/WT21°C) | 38 KG | 85 KG |
| ICE DISPENSING RATE (40G / CUP) | (AT10°C/WT10°C) | APPROX: 78 CUPS / 30 MIN | APPROX: 165 CUPS / 30 MIN |
| | (AT21°C/WT15°C) | APPROX: 73 CUPS / 30 MIN | APPROX: 154 CUPS / 30 MIN |
| | (AT32°C/WT21°C) | APPROX: 67 CUPS / 30 MIN | APPROX: 144 CUPS / 30 MIN |
| WATER CONSUMPTION PER 24H (AT32°C/WT21°C) | 0.038 m ³ | 0.085 m ³ | |
| | 1L / 1KG ICE | 1L / 1KG ICE | |
| STORAGE CAPACITY | 1.9 KG | 4.0 KG | |

• **WARRANTY:**
Two years parts & labour for entire unit, 3rd year on compressor only. Excluding door & exterior damages

• **OPERATING CONDITIONS:** • Rated Voltage : ±6% • Ambient Temperature: 5°-40°C
• Water Supply: 5°-35°C / 0.05-0.78 Mpa • AC Supply Voltage: 1/220-240V / 50 Hz

RI