

1. Proper grounding is required.
2. The installation site must be clean, dust-free and well ventilated.
3. The external piping must be insulated to prevent condensation.
4. The external piping must have equivalent resistance.
5. The rated properties are based on measurements at ambient temperature 30° C(86° F), water temperature 25° C(77° F), electrolytic voltage 13V, electrolytic current 10A and production rate 1L/min(0.26 gal/min), by using Peachtree City water.
6. The minimum water supply pressure of 0.15MPa(22 PSIG) will be required for selection of the "High" production rate.
7. Install the product properly in accordance with the instructions on location, water supply/drain connections and electrical connections stated in the instruction and installation manuals provided. Allow 10mm(0.4") extra space at the installation site to meet any installation requirements (additional spacing is also required for proper water connections).

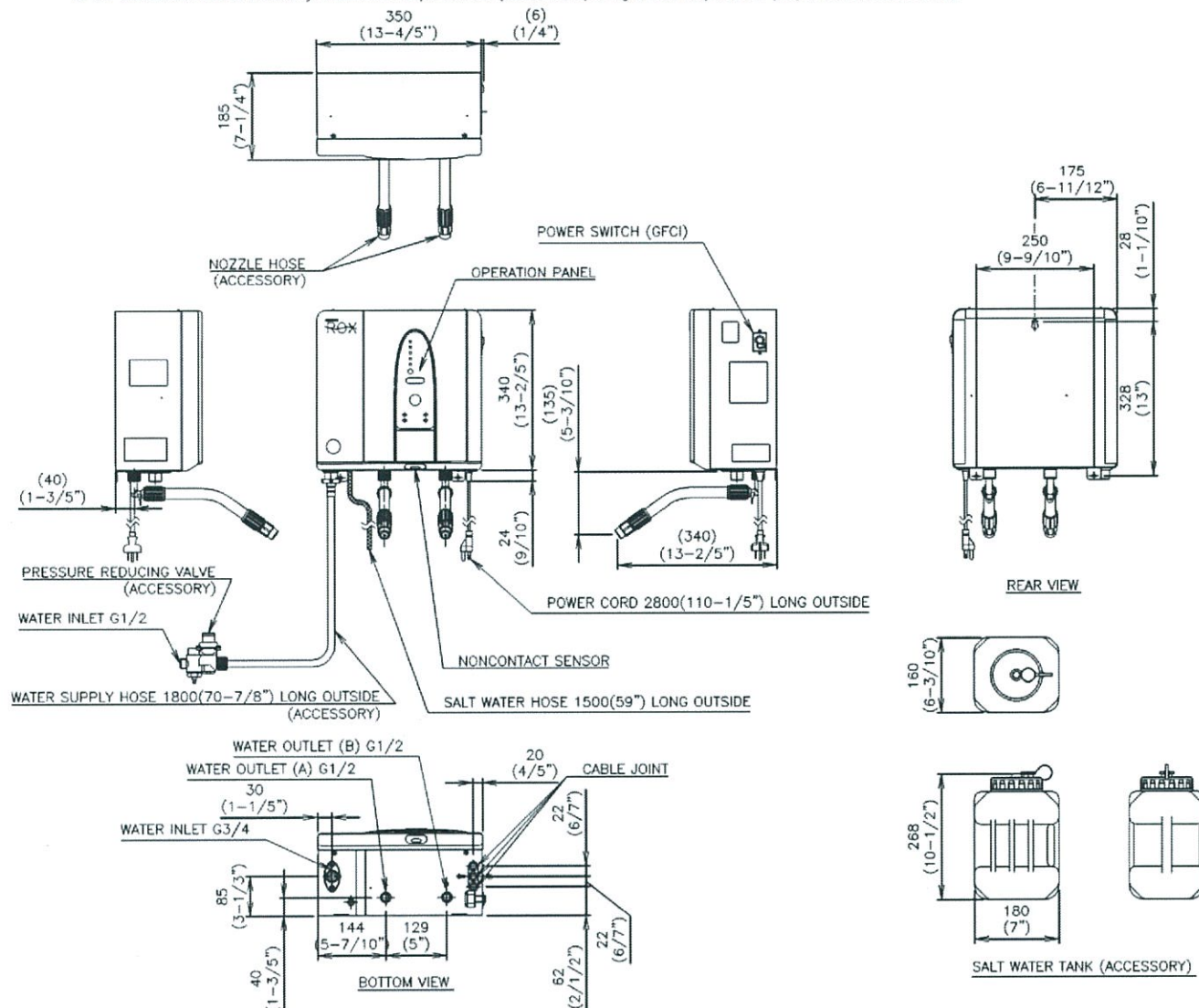

ITEM	Hoshizaki Water Electrolyzer	
MODEL	ROX-10WB-EWS	
POWER SUPPLY	1 Phase 100 - 240V 50/60Hz	
AMPERAGE	2.0A	
ELECTRIC CONSUMPTION	170W	
STANDARD PERFORMANCE	PRODUCTION RATE	Acid/Alkaline Water: Approx. 1.0L/min(0.26 gal/min)
	AVAILABLE CHLORINE	Acid Water: 20 mg/kg or more(0.17 lbs x 10/gal or more)
REFERENCE PERFORMANCE	pH	Acid Water: Approx. 3 or less, Alkaline Water: Approx. 11 or more [Note] Water Temp 25 (77° F), Electrolytic Voltage 13V, Electrolytic Current 10A (Peachtree City Water)
	PRODUCTION RATE	Acid/Alkaline Water: Approx. 0.7 - 1.3 L/min(0.26 - 0.4 gal/min) (Min. water supply pressure of 0.15MPa(22 PSIG) required to ensure 1.0 - 1.5 L/min(0.26 - 0.4 gal/min))
REFERENCE PERFORMANCE	AVAILABLE CHLORINE	Acid Water: Min. 10 mg/kg(0.09 lbs x 10/gal) (Production Rate: Approx. 1.5 L/min(0.4 gal/min))
	pH	Acid Water: Approx. 2.9 - 3.3, Alkaline Water: Approx. 10.5 - 11.0 [Note] Depends on raw water quality and temperature
OUTSIDE DIMENSIONS	350mm(13-4/5")W x 185mm(7-1/4")D x 340mm(13-2/5")H	
EXTERIOR	Galvanized Steel (Polyester Powder Paint), ABS Plastic	
INTERIOR	Stainless Steel, Galvanized Steel (Polyester Powder Paint)	
ELECTROLYSIS SYSTEM	Membrane Technology	
DILUTE SALT WATER ADJUSTMENT SYSTEM	Direct Electromagnetic Pump Injection Method	
ELECTROLYTIC CURRENT ADJUSTMENT SYSTEM	Automatic Adjustment (with Water Temp Correction)	
PRODUCTION RATE ADJUSTMENT SYSTEM	Automatic Adjustment by Switch Operation (Low/Standard/High)	
WATER SUPPLY SYSTEM	Direct Connection to Water Main (Accessory pressure reducing valve required) G3/4 (G1/2)	
START/STOP	Push Button Switch, Noncontact Sensor	
DISPLAY	Operation, Ready, Add Salt Water, Replace Cell, Error, Water Outlet (Acid/Alkaline)	
CONNECTIONS	Water Inlet G3/4 (Pressure Reducing Valve G1/2), Water Outlet G1/2	
CELL POLARITY SWITCHING CONTROL	Timer-Programmable Controller (Protection for power failure)	
CELL POWER SUPPLY	Constant Voltage DC Power Supply (150W)	
CELL REPLACEMENT TIME	Timer-Programmable Controller (Protection for power failure)	
SALT WATER USAGE CONTROL	Pumping Number Counting	
DILUTE SALT WATER CONCENTRATION	Automatic Adjustment by Electrolytic Voltage and Current	
ELECTRIC CIRCUIT PROTECTION	Ground Fault Interrupter (with Overcurrent Protector), Grounding Wire, Fuse (for PC Board: 5A)	
SAFETY DEVICE PROTECTION	Emergency Stop by Microprocessor Control	
WEIGHT	Approx. 13 kg(33 lbs) (16 kg(Gross 40 lbs))	
PACKAGE	Carton 610mm(24")W x 250mm(9-4/5")D x 452mm(17-4/5")H	
CERTIFICATION	-	
ACCESSORIES	Salt Water Tank (5L(1.3 gal)), Cap, Water Supply Hose, Nozzle Hose (x 2), pH Tester (TB, AZY), Chlorine Tester, Measuring Cup, Gasket, Pressure Reducing Valve (22 PSIG), Operation Sheet, Screw Collar, Anchor Bolt, Wood Screw, Rubber Dropper, Shower Nozzle, Straight Nozzle, O-ring, Elbow Assy	
INSTALLATION CONDITIONS	Ambient Temp: 5 - 35° C(40 - 95° F) Water Temp: 5 - 30° C(40 - 86° F) Relative Humidity: Max. 85% (No condensation) Water Supply Pressure: 0.10 - 0.75MPa(22 - 109 PSIG) Voltage Range: Rated Voltage±10% Installation Site: Indoor, Ventilation required Water Supply: Comply with local water and sewerage requirements, Water Softener and Filter required Salt: Min. Purity 99%	

Based on Specs. No. SS-02928